

SOCKET REDUCING HEXAGON

Brand Name: **elson**

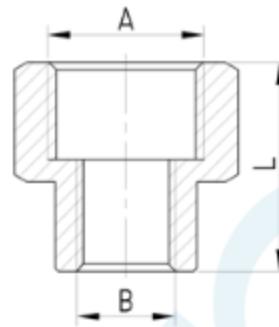

CODE	DESCRIPTION	L(mm)	A	B
81621	SOCKET RED HEX 6mm x 4mm (1/4"X1/8") BRASS	18	G1/8	G1/4
81626	SOCKET RED HEX 10mm x 6mm (3/8"X1/4") BRASS	26	G3/8	G1/4
81628	SOCKET RED HEX 15mm x 6mm (1/2"X1/4") BRASS	30	G1/2	G1/4
81630	SOCKET RED HEX 15mm x 10mm BRASS	30	G1/2	G3/8
81634	SOCKET RED HEX 20mm x 15mm BRASS	34	G3/4	G1/2
81636	SOCKET RED HEX 25mm x 20mm BRASS	38	G1	G3/4

Product Specification & Features

- Maximum Working Temperature: 95°C
- Maximum Working Pressure at 20°C : Water-2000Kpa, Gas-500KPa
- Threads: Complies with AS ISO 7.1, AS ISO 7.2 and AS 1722.2
- Material: DR Brass, Complies with AS 2345
- Suitable for Potable Water – complies with AS/NZS 4020

Standards & Approvals



Elson Australasia Pty Ltd

Tel: 02 9625 7899 Fax: 02 9625 7855

Website: www.elson.net.au E-mail: sales@elson.net.au

Version 1.0

Nov. 2020