

**UNION C×F COPPER OLIVE**

Brand Name: **elson**

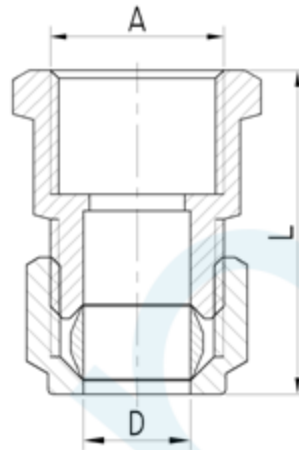

CODE	DESCRIPTION	L(mm)	D	A
87100	UNION CxF 20mm C x 20mm FI BRS C/O	44	DN20	G3/4
87102	UNION CxF 15mm C x 20mm FI BRS C/O	45	DN15	G3/4
87104	UNION CxF 20mm C x 15mm FI BRS C/O	44	DN20	G1/2
87106	UNION CxF 25mm C x 25mm FI BRS C/O	51	DN25	G1
87196	UNION CxF 10mm C x 15mm FI BRS C/O	45	DN10	G1/2
87198	UNION CxF 15mm C x 15mm FI BRS C/O	39	DN15	G1/2
87199	UNION CxF 15mm C x 15mm FI CP C/O	39	DN15	G1/2

**Product Specification & Features**

- Maximum Working Temperature: 95°C
- Maximum Working Pressure at 20°C : 2000Kpa
- Threads: Complies with AS 1722.2
- Material: DR Brass, Complies with AS 2345
- Suitable for Potable Water – complies with AS/NZS 4020



**Elson Australasia Pty Ltd**

Tel: 02 9625 7899 Fax: 02 9625 7855

Website: www.elson.net.au E-mail: sales@elson.net.au

Version 1.0

Nov. 2020