

EasyDRAIN™ EDGE

AUSTRALIAN
MADE & DESIGNED



Installed under the surface, **EasyDRAIN™ Edge** is the seamless drainage system with 20mm edge that captures low rainfall and surface water.

MADE FROM RECYCLED PLASTIC · COMPLETELY RUST FREE



INSTALLED
PRODUCT!



INSTALLED
PRODUCT!



ABOUT EDGE

This new to market, architecturally designed, drainage system works seamlessly with your tiles and pavers to create a completely concealed finish.

Installed under the surface, EasyDRAIN™ Edge creates new landscaping opportunities for patios, swimming pools, balconies and other outdoor areas without compromising on your water collection needs.

Proudly manufactured in Australia using recycled plastics, EasyDRAIN™ Edge has been designed for the elements and is the ultimate concealed drainage system for Australian homes.



HEEL FRIENDLY INSERT (OPTIONAL)

Converts the system to a heel friendly option for pedestrian activity. The insert works with pavers of a max height of 50mm and can be adjusted for smaller pavers in increments of 10mm.

ACCESS PIT

This is where debris will collect and the access point to clean your drainage. To ensure access to the system the paver needs to be removable on this part.

SLOT

20mm slot captures waterflow into channel.

PAVERS

Installed on top of grate, pavers/tiles are adhered to the grate using adhesive sealant

CONCRETE

EARTH

CHANNEL & GRATE

1 metre channel & grate length available, designed with click together interlocking technology.

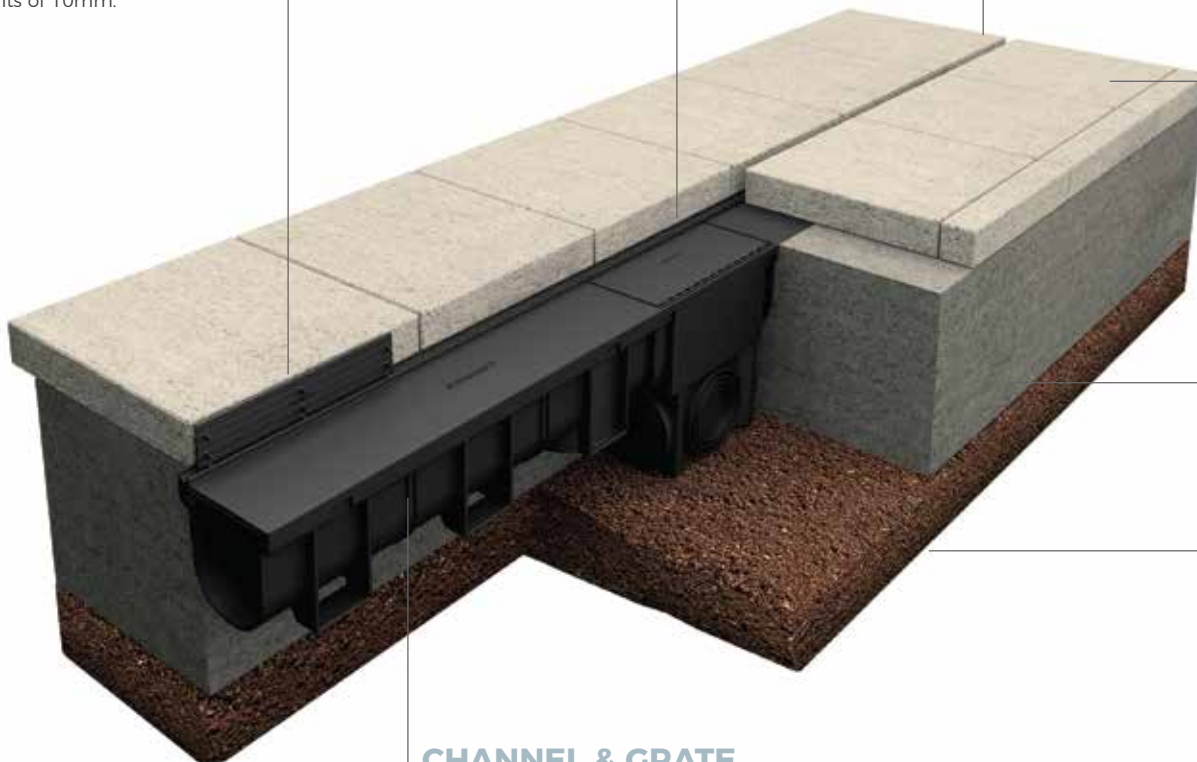

thank you.



Thank you for choosing an Everhard Industries polymer product.

Every year we recycle more than 1.5 million kg of Australian polymer to create the product you're taking home today. When you think our EasyDRAIN™ Standard Channel & Grate weighs 2.5kg, that's a whole lot of products made from recycled material! We are an Australian manufacturer who cares about drainage solutions and even more about Australia!

choose recycled - choose polymer.

INSTALLED
PRODUCT!



THE SYSTEM

EasyDRAIN™ Edge connects to all EasyDRAIN™ Standard components, making it a fully integrated surface water drainage solution.

EI CODE

83210
83215
83220
83220
83220
83230

DESCRIPTION

EasyDRAIN Edge 1m Channel & Grate
EasyDRAIN Edge Access Pit & Grate
EasyDRAIN Edge Internal Corner & Grate
EasyDRAIN Edge External Corner & Grate
EasyDRAIN Edge Heel Friendly Insert

83360
83370
84040

EasyDRAIN Standard End Cap
EasyDRAIN Standard Converter
EasyDRAIN Flo-way Leaf Dome



SEE HOW IT WORKS!

ACCESS INSTALLATION
VIDEO, INSTRUCTIONS, IMAGES



A BRIEF HISTORY

From the beginning of our proud history in concrete laundry tubs, to our advanced wastewater dispersal & management systems, Everhard Industries has evolved into one of the largest suppliers of plumbing and drainage solutions in Australia.

AND TODAY

Everhard today is a fourth-generation, family-owned Australian manufacturer with branches and distribution sites across Australia. With more than 90 years of experience creating quality innovative products and services, we are focused on building a lasting legacy, backed by the Everhard name.

Everhard will continue to innovate as a key Australian manufacturer and distributor for years to come, staying at the leading edge of Everything Water.

everhard.com.au | 131 926