



**SPECIFICATIONS &
INSTALLATION GUIDE**

ANOTHER QUALITY
PRODUCT BY
FORZA GLOBAL

Warranty



History tells us Market needs often dictate product development.

We also know that products used in different regions around the globe may not be suitable for the Harsh Australian environment that requires dedicated product development that will stand the test of time.

At FORZA GLOBAL, we understand this. Our research team spend significant time & effort testing our product to ensure it meets the need of the Australian market.



- All fittings across our gas and water range are made of the premium quality, corrosion resistant, DR Brass providing both reliability and strength to stand the test of time.
- Fittings are solvent resistant and can confidently be exposed to petroleum based products.
- UV Resistant to handle the harsh Australian conditions.
- Warehoused in Australia by FORZA GLOBAL assuring availability of supply across the range.

We believe in the quality of our product at FORZA GLOBAL, therefore we are proud to announce a 50 year warranty on both our gas and water systems.





FORZA GLOBAL are the manufacturers and distributors of FORZA PE-Xa PIPING Systems which includes the BRASS FITTING COPPER RING CRIMP system for potable water, rainwater and recycled water. FORZA GLOBAL also manufacture and distribute FORZA PEX / AL /PE

GAS System, FORZA STAINLESS CRIMP system and BRASS SLIDE RING COMPRESSION SLEEVE system. This manual provides specification and installation information for the FORZA Plumbing Systems for Hot and Cold Water.

FORZA FOR POTABLE WATER, RAINWATER AND RECYCLED WATER SIMPLE, SAFE, SECURE

The FORZA Plumbing System comprises of three components; a flexible cross linked high density polyethylene pipe, solid forged DR brass with copper ring fittings and special CRIMP tools.

All products are manufactured to strict quality controls and comply with Australian Standards, are watermarked approved and fully warranted for 50 years.

The superior material properties of FORZA are ideal for hot and cold water services. The system is hygienic and non-toxic, providing clean and clear drinking water without the inherent problems of conventional plumbing systems which include chlorine, corrosion and scale.

Colour coded pipe is available in BLACK and RED for potable water, GREEN for harvested rainwater and LILAC for recycled water. FORZA is suitable for domestic and commercial applications.

FORZA cross linked high-density polyethylene (PE-Xa) offers flexibility and impact resistance with a smooth bore design resulting in quiet delivery minimizing water hammer and noise attributed to fluctuations in hydraulic pressure.

The FORZA CRIMP ring connection eliminates leakages and system failures when installed following installation guidelines. With specially designed tools, FORZA Plumbing Systems are suitable for installation by licensed plumbers.

FORZA's simple joint method involves cutting the pipe square, pushing the pipe onto the fitting ensuring pipe is visible through the viewing port in the copper ring, followed by crimping the ring with the FORZA approved crimp tool. System must be tested in accordance with AS/NZ 3500.1

The FORZA PE-Xa Plumbing System joint can be made without the need for flame, heat, solder, or solvents.



SPECIFICATIONS

- Pipe made from Peroxide- cross linked polyethylene (PE-Xa)
 - Used for Hot and Cold Water Services
 - Thermal Conductivity :0.35 W/m.K
 - Roughness: 0.007mm
 - Maximum Temperature: 95 Deg C
 - Short-term Temperature in case of HWS malfunction : 100 Deg
 - Fittings are made from dezincification-resistance brass
 - Pipe Dimension : 16 to 50
 - Suitable for both Wet and Dry construction
 - Approval Mark International Product Certification to Australian Standards
-

CRIMP TOOLS

FORZA Plumbing systems tools have been designed to ensure a leak proof joint. The crimp tools have been manufactured with the highest quality material and designed to give long term trouble free service. FORZA also offer the option of both manual and battery tools.

WARRANTY

FORZA Plumbing System (excluding tooling) is warranted for 50 years when installed by a licensed plumber in accordance with AS 3500 of the National Plumbing Code Parts 1, 4 and 5 and established installation practices.

AUSTRALIAN STANDARDS COMPLIANCE

FORZA Plumbing System is licensed by Approval Mark International to Australian Standards and complies with Australian and New Zealand Standards AS/NZ 2492:2007 for Pipe (Lic.No.74616) and AS 2537:2-2011 for fittings (Lic. No. 74615)

TEST PROCEDURE FOR WATERMARK COMPLIANCE

Listed below are the characteristics that are being tested for as well as the code from which the method for testing is followed:

- Slow crack growth - ISO 13479
- Long term stability - ISO 1167 or AS 1462.6
- Thermal stability – ISO/TR 10837
- Resistance to weathering – ISO 14531-1
- Longitudinal reversion – ISO 2505
- Hydrostatic strength – ISO 1167 or AS 1462.6
- Elongation at break - ISO 6259-1, ISO 6259-3
- Effect on water- AS 4020
- Opacity- ISO 7686
- Diameter and wall thickness - AS/NZS 1462.1
- Degree of cross linking - ISO 10147



PRESSURE LOSS TABLES FOR PN20 PE-X_a PIPE

COLD WATER AT 25°C

PEAK FLOW RATE QS (L/S) .01 TO .50	16MM X 2.2 HEAD LOSS (KPA/M)	20MM X 2.8 HEAD LOSS (KPA/M)	25MM X 3.5 HEAD LOSS (KPA/M)	32MM X 4.4 HEAD LOSS (KPA/M)
0.05	0.3465	0.1242	-	-
0.10	1.1650	0.4141	0.1430	0.0430
0.15	2.3930	0.8455	0.2905	0.0866
0.20	4.0077	1.4090	0.4822	0.1430
0.25	5.9950	2.1001	0.7160	0.2122
0.30	8.3490	2.9143	0.9908	0.2927
0.35	11.0620	3.8498	1.3053	0.3846
0.40	14.1295	4.9036	1.6589	0.4879
0.45	-	6.0756	2.0510	0.6018
0.50	-	7.3633	2.4808	0.7266

HOT WATER AT 60°C

PEAK FLOW RATE QS (L/S) .01 TO .50	16MM X 2.2 HEAD LOSS (KPA/M)	20MM X 2.8 HEAD LOSS (KPA/M)	25MM X 3.5 HEAD LOSS (KPA/M)	32MM X 4.4 HEAD LOSS (KPA/M)
0.05	0.2913	0.0135	0.0358	0.0106
0.10	1.0002	0.3520	0.1205	0.0357
0.15	2.0803	0.7270	0.2475	0.0731
0.20	3.5175	1.2222	0.4140	0.1218
0.25	5.3030	1.8343	0.6185	0.1814
0.30	7.4321	2.5605	0.8685	0.2515
0.35	9.9026	3.3998	1.1392	0.3318
0.40	12.7115	4.3509	1.4535	0.4223
0.45	-	5.4121	1.8038	0.5228
0.50	-	6.5836	2.1891	0.6329



FORZA PIPE PACKAGING

PIPE SIZE	BLACK
16MM	5M LENGTHS, 100M COILS
20MM	5M LENGTHS, 100M COILS
25MM	5M LENGTHS, 50M COILS
32MM	5M LENGTHS, 50M COILS
40MM	5M LENGTHS
50MM	5M LENGTHS

PIPE SIZE	RED
16MM	5M LENGTHS, 100M COILS
20MM	5M LENGTHS, 100M COILS
25MM	5M LENGTHS, 50M COILS
32MM	5M LENGTHS, 50M COILS

PIPE SIZE	LILAC	GREEN
16MM	5M LENGTHS, 50M COILS	5M LENGTHS, 50M COILS
20MM	5M LENGTHS, 50M COILS	5M LENGTHS, 50M COILS
25MM	5M LENGTHS, 50M COILS	5M LENGTHS, 50M COILS

NOM OD	MEAN OUTSIDE DIA (MM)		WALL THICKNESS (MM)	
	MIN	MAX	MIN	MAX
DN 16-16MM	16.0	16.3	2.2	2.6
DN 20-20MM	20.0	20.3	2.8	3.2
DN 25-25MM	25.0	25.3	3.6	4.0
DN 32-32MM	32.0	32.3	4.4	5.0
DN 40-40MM	40.0	40.4	5.5	6.2
DN 50-50MM	50.0	50.5	6.9	7.7

PRESSURE RATINGS

Pipes for water applications are classified in terms of the nominal pressure rating (PN) at water service temperature of 20°C. FORZA has a pressure rating of PN20 and a nominal working pressure and pipe material temperature (PMT).

PMT	20C	60C	70C
PN			
20	KPA 2000	1500	1330



CERTIFICATE OF CONFORMITY

ApprovalMark International hereby grants:

FORZA Global Pty Ltd

2/8 Barclay Road
Derrimut, 3030
AUSTRALIA

WaterMark Certificate of Conformity – WMCS 2016

Evaluated to:

AS/NZS 2492:2007 - Cross-linked polyethylene (PE-X) pipes for pressure applications

The WaterMark licensee shall comply with all the terms and conditions as stipulated by the governance of the operating rules of WaterMark, and shall comply with standard requirement at all times including when standard is amended. The WaterMark license only covers the product which is identified in the product schedule.

This certificate is issued by a JAS-ANZ accredited certification body. The ABCB and JAS-ANZ do not in any way warrant, guarantee or represent that the product the subject of this Certificate conforms to the WaterMark Certification Scheme Rules, nor accepts any liability arising out of the use of the product. The ABCB disclaims to the extent permitted by law, all liability (including negligence) for claims of losses, expenses, damages and costs arising as a result of the use of the product(s) referred to in this certificate.

* This certificate may only be reproduced in its entirety.

Certificate No. WM 74817

Issued: 1st July 2019

Expires: 1st July 2024

Originally Certified: 1st July 2019

Current Certification: 1st July 2019

John PRASAD

Director
ApprovalMark International Pty Ltd
20/33 Holbeche Road, Arndell Park 2148, Australia
www.approvalmark.com

ApprovalMark



ApprovalMark Certification



WaterMark

FORZA WATER CRIMP FITTINGS LIST

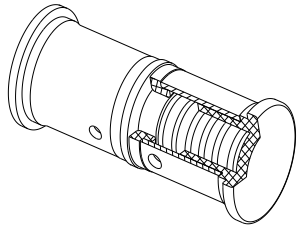

CODE	SIZE	DESCRIPTION
COUPLING		
FCSC16	DN16	FORZA WATER CRIMP NO.1 STRAIGHT COUPLING 16MM
FCSC20	DN20	FORZA WATER CRIMP NO.1 STRAIGHT COUPLING 20MM
FCSC25	DN25	FORZA WATER CRIMP NO.1 STRAIGHT COUPLING 25MM
FCSC32	DN32	FORZA WATER CRIMP NO.1 STRAIGHT COUPLING 32MM

REDUCING COUPLING		
FCRC2016	DN20-16	FORZA WATER CRIMP NO.1 REDUCING COUPLING 20MM X 16MM
FCRC2516	DN25-16	FORZA WATER CRIMP NO.1 REDUCING COUPLING 25MM X 16MM
FCRC2520	DN25-20	FORZA WATER CRIMP NO.1 REDUCING COUPLING 25MM X 20MM
FCRC3220	DN32-20	FORZA WATER CRIMP NO.1 REDUCING COUPLING 32MM X 20MM
FCRC3225	DN32-25	FORZA WATER CRIMP NO.1 REDUCING COUPLING 32MM X 25MM

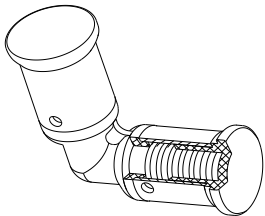

ELBOW		
FCE16	DN16	FORZA WATER CRIMP NO.12 EQUAL ELBOW 16MM
FCE20	DN20	FORZA WATER CRIMP NO.12 EQUAL ELBOW 20MM
FCE25	DN25	FORZA WATER CRIMP NO.12 EQUAL ELBOW 25MM
FCE32	DN32	FORZA WATER CRIMP NO.12 EQUAL ELBOW 32MM

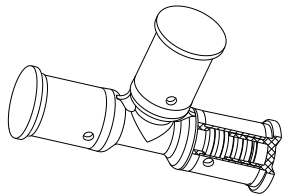

EQUAL TEE		
FCET16	DN16	FORZA WATER CRIMP NO.24 EQUAL TEE 16MM
FCET20	DN20	FORZA WATER CRIMP NO.24 EQUAL TEE 20MM
FCET25	DN25	FORZA WATER CRIMP NO.24 EQUAL TEE 25MM
FCET32	DN32	FORZA WATER CRIMP NO.24 EQUAL TEE 32MM

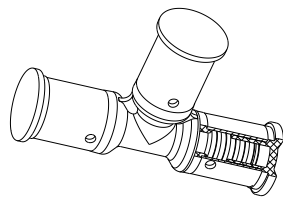

CENTRE REDUCING TEE		
FCRT202016	DN20X20X16	FORZA WATER CRIMP NO.25 REDUCING TEE 20MM X 20MM X 16MM
FCRT252516	DN25X25X16	FORZA WATER CRIMP NO.25 REDUCING TEE 25MM X 25MM X 16MM
FCRT252520	DN25X25X20	FORZA WATER CRIMP NO.25 REDUCING TEE 25MM X 25MM X 20MM
FCRT323216	DN32X32X16	FORZA WATER CRIMP NO.25 REDUCING TEE 32MM X 32MM X 16MM
FCRT323220	DN32X32X20	FORZA WATER CRIMP NO.25 REDUCING TEE 32MM X 32MM X 20MM
FCRT323225	DN32X32X25	FORZA WATER CRIMP NO.25 REDUCING TEE 32MM X 32MM X 25MM

END REDUCING TEE		
FCRT201620	DN20X16X20	FORZA WATER CRIMP NO.26 REDUCING TEE 20MM X 16MM X 20MM
FCRT251625	DN25X16X25	FORZA WATER CRIMP NO.26 REDUCING TEE 25MM X 16MM X 25MM
FCRT252025	DN25X20X25	FORZA WATER CRIMP NO.26 REDUCING TEE 25MM X 20MM X 25MM

END AND CENTRE REDUCING TEE		
FCRT201616	DN20X16X16	FORZA WATER CRIMP NO.27 REDUCING TEE 20MM X 16MM X 16MM
FCRT251616	DN25X16X16	FORZA WATER CRIMP NO.27 REDUCING TEE 25MM X 16MM X 16MM
FCRT252020	DN25X20X20	FORZA WATER CRIMP NO.27 REDUCING TEE 25MM X 20MM X 20MM

FORZA WATER CRIMP FITTINGS LIST

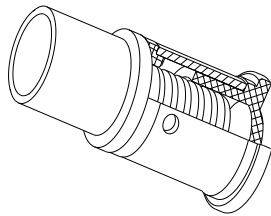

CODE	SIZE	DESCRIPTION
CONNECTING BARB SPIGOT		
FCCB16	DN16	FORZA WATER CRIMP CONNECTING BARB 16MM X 1/2" CU
FCCB20	DN20	FORZA WATER CRIMP CONNECTING BARB 20MM X 3/4" CU
FCCB25	DN25	FORZA WATER CRIMP CONNECTING BARB 25MM X 1" CU
FCCB32	DN32	FORZA WATER CRIMP CONNECTING BARB 32MM X 1-1/4" CU

CONNECTING BARB SOCKET		
FCCBS16	DN16	FORZA WATER CRIMP CONNECTING BARB 16MM X 1/2" CU
FCCBS20	DN20	FORZA WATER CRIMP CONNECTING BARB 20MM X 3/4" CU
FCCBS25	DN25	FORZA WATER CRIMP CONNECTING BARB 25MM X 1" CU
FCCBS32	DN32	FORZA WATER CRIMP CONNECTING BARB 32MM X 1-1/4" CU

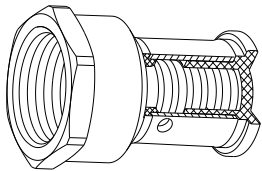

FEMALE CONNECTOR		
FCFSC1615	DN16X1/2"FI	FORZA WATER CRIMP NO.2 STRAIGHT CONNECTOR 16MM X 1/2" BSP FEMALE
FCFSC1620	DN16X3/4"FI	FORZA WATER CRIMP NO.2 STRAIGHT CONNECTOR 16MM X 3/4" BSP FEMALE
FCFSC2015	DN20X1/2"FI	FORZA WATER CRIMP NO.2 STRAIGHT CONNECTOR 20MM X 1/2" BSP FEMALE
FCFSC2020	DN20X3/4"FI	FORZA WATER CRIMP NO.2 STRAIGHT CONNECTOR 20MM X 3/4" BSP FEMALE
FCFSC2520	DN25X3/4"FI	FORZA WATER CRIMP NO.2 STRAIGHT CONNECTOR 25MM X 3/4" BSP FEMALE
FSFSC2525	DN25X1"FI	FORZA WATER CRIMP NO.2 STRAIGHT CONNECTOR 25MM X 1" BSP FEMALE
FCFSC3225	DN32X1"FI	FORZA WATER CRIMP NO.2 STRAIGHT CONNECTOR 32MM X 1" BSP FEMALE
FCFSC3232	DN32X1 1/4"FI	FORZA WATER CRIMP NO.2 STRAIGHT CONNECTOR 32MM X 1 1/4" BSP FEMALE

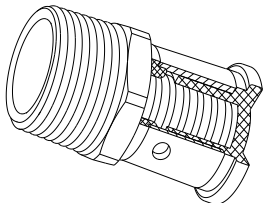

MALE CONNECTOR		
FCMSC1615	DN16X1/2"M	FORZA WATER CRIMP NO.3 STRAIGHT CONNECTOR 16MM X 1/2" BSP MALE
FCMSC1620	DN16X3/4"M	FORZA WATER CRIMP NO.3 STRAIGHT CONNECTOR 16MM X 3/4" BSP MALE
FCMSC2015	DN20X1/2"M	FORZA WATER CRIMP NO.3 STRAIGHT CONNECTOR 16MM X 1/2" BSP MALE
FCMSC2020	DN20X3/4"M	FORZA WATER CRIMP NO.3 STRAIGHT CONNECTOR 16MM X 3/4" BSP MALE
FCMSC2515	DN25X1/2"M	FORZA WATER CRIMP NO.3 STRAIGHT CONNECTOR 25MM X 1/2" BSP MALE
FCMSC2520	DN25X3/4"M	FORZA WATER CRIMP NO.3 STRAIGHT CONNECTOR 25MM X 3/4" BSP MALE
FCMSC2525	DN25X1"M	FORZA WATER CRIMP NO.3 STRAIGHT CONNECTOR 25MM X 1" BSP MALE
FCMSC3225	DN32X1"M	FORZA WATER CRIMP NO.3 STRAIGHT CONNECTOR 32MM X 1" BSP MALE
FCSMC3232	DN32X1 1/4"M	FORZA WATER CRIMP NO.3 STRAIGHT CONNECTOR 32MM X 1-1/4" BSP MALE

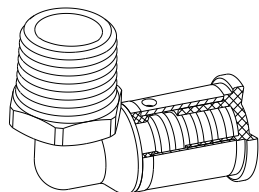

MALE ELBOW		
FCME1615	DN16X1/2"M	FORZA WATER CRIMP NO.13 ELBOW 16MM X 1/2" BSP MALE
FCME2015	DN20X1/2"M	FORZA WATER CRIMP NO.13 ELBOW 20MM X 1/2" BSP MALE
FCME2020	DN20X3/4"M	FORZA WATER CRIMP NO.13 ELBOW 16MM X 1/2" BSP MALE
FCME2520	DN25X3/4"M	FORZA WATER CRIMP NO.13 ELBOW 25MM X 3/4" BSP MALE
FCME2525	DN25X1"M	FORZA WATER CRIMP NO.13 ELBOW 16MM X 1/2" BSP MALE

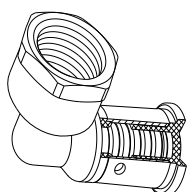

FEMALE ELBOW		
FCFE1615	DN16X1/2"F	FORZA WATER CRIMP NO.14 ELBOW 16MM X 1/2" BSP FEMALE
FCFE2015	DN20X1/2"F	FORZA WATER CRIMP NO.14 ELBOW 20MM X 1/2" BSP FEMALE
FCFE2020	DN20X3/4"F	FORZA WATER CRIMP NO.14 ELBOW 20MM X 3/4" BSP FEMALE

FORZA WATER CRIMP FITTINGS LIST

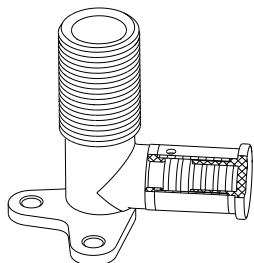

CODE	SIZE	DESCRIPTION
MALE LUGGED ELBOW		
FCWM161565	DN16X1/2"MI-65	FORZA WATER CRIMP NO.19BP ELBOW 16MM X 1/2" BSP MALE 65MM LONG
FCWM161590	DN16X1/2"MI-90	FORZA WATER CRIMP NO.19BP ELBOW 16MM X 1/2" BSP MALE 90MM LONG
FCWM201595	DN20X1/2"MI-95	FORZA WATER CRIMP NO.19BP ELBOW 16MM X 1/2" BSP MALE 95MM LONG
FCWM202095	DN20X3/4"MI-95	FORZA WATER CRIMP NO.19BP ELBOW 20MM X 3/4" BSP MALE 95MM LONG

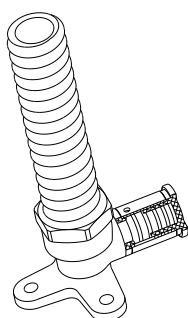

EXTENDED MALE LUGGED ELBOW		
FCWM1615150	DN16X1/2"MI-150	FORZA WATER CRIMP NO.19BP ELBOW 16MM X 1/2" BSP MALE 150MM LONG
FCWM1615200	DN16X1/2"MI-200	FORZA WATER CRIMP NO.19BP ELBOW 16MM X 1/2" BSP MALE 200MM LONG
FCWM2015200	DN20x1/2"MI-200	FORZA WATER CRIMP NO.19BP ELBOW 20MM X 1/2" BSP MALE 200MM LONG
FCWM2020200	DN20x3/4"MI-200	FORZA WATER CRIMP NO.19BP ELBOW 20MM X 3/4" BSP MALE 200MM LONG

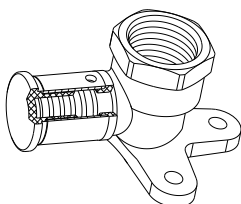

FEMALE LUGGED ELBOW		
FCWF1615	DN16X1/2"FI	FORZA WATER CRIMP NO.15BP LUGGED ELBOW 16MM X 1/2" BSP FEMALE
FCWF2015	DN20X1/2"FI	FORZA WATER CRIMP NO.15BP LUGGED ELBOW 20MM X 1/2" BSP FEMALE
FCWF2020	DN20X3/4"FI	FORZA WATER CRIMP NO.15BP LUGGED ELBOW 20MM X 3/4" BSP FEMALE

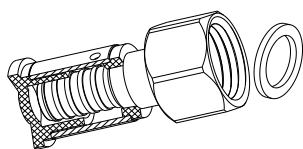

STRAIGHT TAP CONNECTOR		
FCSTC1615	DN16X1/2"FI	FORZA WATER CRIMP NO.62 STRAIGHT TAP CONNECTOR 16MM X 1/2" BSP
FCSTC2020	DN20X3/4"FI	FORZA WATER CRIMP NO.62 STRAIGHT TAP CONNECTOR 20MM X 3/4" BSP

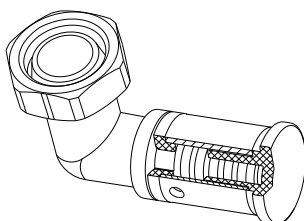

BENT TAP CONNECTOR		
FCBTC1615	DN16X1/2"FI	FORZA WATER CRIMP NO.63 BENT TAPCONNECTOR 16MM X 1/2" BSP
FCBTC2020	DN20X3/4"FI	FORZA WATER CRIMP NO.63 BENT TAPCONNECTOR 20MM X 3/4" BSP

FORZA WATER CRIMP FITTINGS LIST

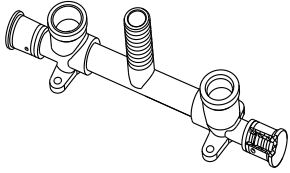
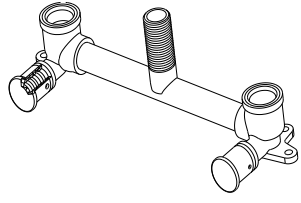
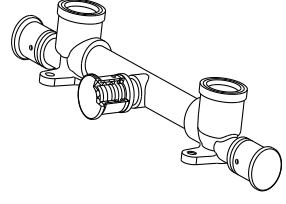
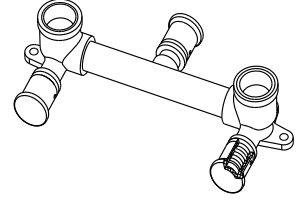
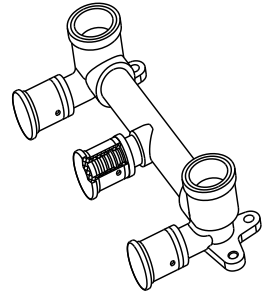
CODE	SIZE	DESCRIPTION
BATH/LAUNDRY ASSEMBLY		
	FCBLAS300	300MM FORZA WATER CRIMP BATH/LAUNDRY ASSEMBLY STRAIGHT 300MM
	FCBLARA200	200MM FORZA WATER CRIMP BATH/LAUNDRY ASSEMBLY RIGHT ANGLE 200MM
	FCBLARA300	300MM FORZA WATER CRIMP BATH/LAUNDRY ASSEMBLY RIGHT ANGLE 300MM
SHOWER ASSEMBLY		
	FCSAS150	150MM FORZA WATER CRIMP SHOWER ASSEMBLY STRAIGHT 150MM
	FCSARA150	150MM FORZA WATER CRIMP SHOWER ASSEMBLY RIGHT ANGLE 150MM
	FCSARA200	200MM FORZA WATER CRIMP SHOWER ASSEMBLY RIGHT ANGLE 200MM
	FCSARA150BU	150MM FORZA WATER CRIMP SHOWER ASSEMBLY BARBS UP 150MM
	FCSARA200BU	200MM FORZA WATER CRIMP SHOWER ASSEMBLY BARBS UP 200MM

FORZA WATER CRIMP FITTINGS LIST

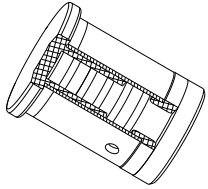

CODE	SIZE	DESCRIPTION
END STOPPER		
FCS16	DN16	FORZA WATER CRIMP NO.61 STOPPER 16MM
FCS20	DN20	FORZA WATER CRIMP NO.61 STOPPER 20MM
FCS25	DN25	FORZA WATER CRIMP NO.61 STOPPER 25MM
FCS32	DN32	FORZA WATER CRIMP NO.61 STOPPER 32MM

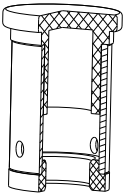

CRIMP RING ASSEMBLY		
FCCR16	DN16	FORZA WATER CRIMP RING ASSEMBLY 16MM
FCCR20	DN20	FORZA WATER CRIMP RING ASSEMBLY 20MM
FCCR25	DN25	FORZA WATER CRIMP RING ASSEMBLY 25MM
FCCR32	DN32	FORZA WATER CRIMP RING ASSEMBLY 32MM

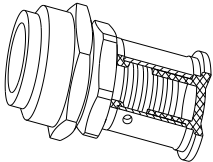

FLARED COMPRESSION CONNECTOR		
FCCU1615	DN16X1/2" CU	FORZA WATER CRIMP FLARED COMPRESSION CONNECTOR 16MM X 1/2" CU
FCCU2020	DN20X3/4" CU	FORZA WATER CRIMP FLARED COMPRESSION CONNECTOR 20MM X 3/4" CU

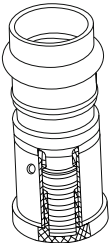

COPPER PRESS ADAPTORS		
FCCP1615	DN16X1/2" CU	FORZA WATER CRIMP 16MM X COPPER PRESS 1/2"
FCCP2020	DN20X3/4" CU	FORZA WATER CRIMP 20MM X COPPER PRESS 3/4"
FCCP2525	DN25 X 1" CU	FORZA WATER CRIMP 25MM X COPPER PRESS 1"
FCCP3232	DN32X1-1/4" CU	FORZA WATER CRIMP 32MM X COPPER PRESS 1-1/4"

WATER CRIMP INSTALLATION INSTRUCTIONS

The following instructions explain the correct installation procedure for FORZA PEX Slide sleeve fittings in conjunction with FORZA PEX pipe.

1



With a set of pipe cutters /shears cut the pipe at 90° ensuring the pipe is square on the end.

2



Push fitting onto pipe until pipe is visible through the viewing port on copper ring. This ensures that pipe has been inserted to the correct depth.

3



Position tool so that the jaws of the tool are in the centre of the copper ring.



4



Proceed to crimp the fitting until jaws of tool are completely closed.



5



Once crimp is complete test with gauge. Gauge will slide over copper ring if it has been done correctly.

At completion of installation a pressure test must be carried out in accordance with AS/NZS 3500 and or any other requirements specified by local authorities.



WATER CRIMP INSTALLATION INSTRUCTIONS



Battery Crimping Tool



Manual Crimping Tool



CERTIFICATE OF CONFORMITY

ApprovalMark International hereby grants:

Forza Global Pty Ltd

2/8 Barclay Road,
Derrimut 3030
AUSTRALIA

WaterMark Certificate of Conformity – Level 1

Evaluated to:

AS/NZS 2537.2: 2011 - Mechanical jointing fittings for use with crosslinked polyethylene (PE-X) for pressure applications - Plastics piping systems for hot and cold water installations - Crosslinked polyethylene (PE-X) - Fittings (ISO 15875-3:2003, MOD)

The WaterMark licensee shall comply with all the terms and conditions as stipulated by the governance of the operating rules of WaterMark, and shall comply with standard requirement at all times including when standard is amended. The WaterMark license only covers the product which is identified in the product schedule.

Certificate No. WM 74615

Issued: 16th July 2015

Expires: 16th July 2020

Originally Certified: 16th July 2015

Current Certification: 16th July 2015

John PRASAD

Certification Manager



ApprovalMark Certification



WaterMark

ApprovalMark



Forza Pex pipe and fittings are guaranteed against manufacturing defects for a period of 50 YEARS when installed and used in accordance of the Australian Plumbing code and or the LOCAL or STATE Authority and when installed by a licensed PLUMBER.



Forza Pex PIPE complies with the standards as set out in AS/NZS 2492:2007 Cross Linked polyethylene (PE-X) pipes for pressure applications.

Licence No. WM74817

Forza Pex FITTINGS comply to the standards as set out in AS/NZS 2537.2:2011 - Mechanical jointed fittings for use with cross linked polyethylene pipe (XLPE) for hot and cold applications.

Licence No. WM74615

a product by



Certificate of Currency

PUBLIC AND PRODUCTS LIABILITY POLICY

INSURED: Forza Global Pty Ltd

BUSINESS ACTIVITY: Import and wholesale of plumbing fixtures, pipes, valves and tools

POLICY NUMBER: BXLC-LIM-2018-002733

PERIOD OF INSURANCE: 22/01/20 to 22/01/21 At 4pm Local Time

LIMIT OF INDEMNITY:

	Limit	Excess
Public Liability	\$50,000,000 any one occurrence	\$2,500 each and every Claim (inclusive of costs and expenses)
Products Liability	\$50,000,000 any one occurrence and in the aggregate for all Injury or Damage occurring during the Period of Insurance	\$2,500 each and every Claim (inclusive of costs and expenses)
Special Excess	\$25,000 each and every occurrence (inclusive of costs and expenses) in respect of Injury to Contractors, Sub-Contractors or Labour Hire Personnel	

Signed for and on behalf of XL Insurance Company SE, Australia branch (ABN 36 083 570 441), trading as Brooklyn Underwriting:



FORZA GLOBAL PTY LTD
ABN 42 161 669 549 ACN 161 669 549
2/8 BARCLAY ROAD, DERRIMUT, VIC 3030
T: (03) 8348 5704 F: (03) 9923 6324
WWW.FORZAGLOBAL.COM.AU